

Plat of Survey

of

Lot 1 of Block 6 of Dann's Addition,

a subdivision located in the Northeast 1/4 of Section 4, Town 4 North, Range 15 East, City of Whitewater, Walworth County, Wisconsin.

Surveyed for: **Nick Baldwin**
306 East Cravath Street
Whitewater, Wisconsin. 53190

Lot 1

Lot 2

Stritzel

Subdivision

Alley

(19.8' Wide)

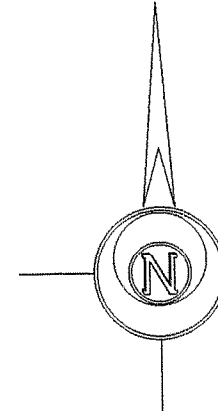

Bearings reference to previous surveys of record.

Cherry Street

(60' Wide)

Lot 1
0.250 Acre
10,888 Sq.Ft.

House
No. 306

Lot 2

Block 6

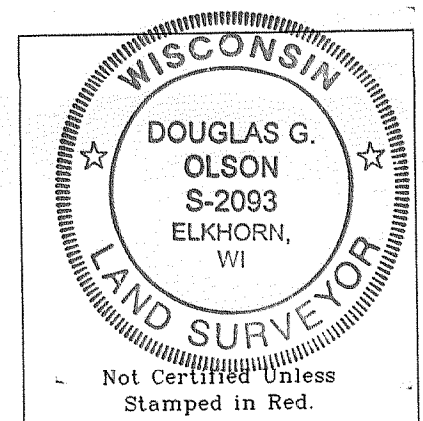

Notes: 1) This survey plat is not certified unless signed and sealed in red ink.

2) This survey is subject to Wisconsin lien laws. This Plat of Survey is the notice of intent to file lien. Lien waiver required.

Cravath Street

(60' Wide)

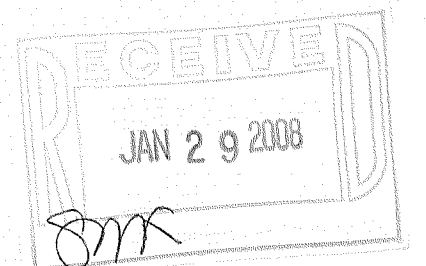

Copyright © 2007 by Jensen & Olson Land Surveying, LLC.

All rights reserved. No part of this survey plat may be reproduced or transmitted in any form by any means - graphic, electronic, or mechanical, including photocopying, tracing, or information storage and retrieval systems without permission in writing from Douglas G. Olson, Jensen & Olson Land Surveying, LLC.

I, Douglas G. Olson, Wisconsin Registered Land Surveyor, do hereby certify that this survey was performed by me or under my direction in full compliance with the owner's/agent's instructions and Chapter A-E 7 of the Wisconsin Administrative Code "Minimum Standards for Property Surveys" and that this map is an accurate representation thereof to the best of my knowledge and belief.

Douglas G. Olson
Wisconsin Registered Land Surveyor - 2093

2007.134

Sheet 1 of 1 Sheets

Job Reference Number

2007.134

Legend

- Found Concrete Monument
- Found Iron Pipe, 2" dia.
- Found Iron Rod, 3/4" dia.
- Found Nail in concrete
- Set Iron Rod, 1-3/16" dia. 3/4" dia.
- Recorded Information
- Utility Pole
- Manhole
- Hydrant
- Catch Basin
- Asphalt Surface
- Gravel
- Concrete Surface
- Brick Pavers

Jensen & Olson Land Surveying, LLC

45 South Wisconsin Street P.O. Box 322
Elkhorn, Wisconsin. 53121
Telephone (262) 723-3434
Facsimile (262) 723-8044

Scale in Feet

1" = 20'

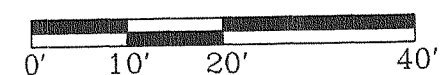

Survey Date: October 18, 2007.

Revisions:

010-844